

88.0843 ACRES
(1.410 AC. IN R/W)

ANTHONY STACHOWSKI
1739-2A68
32-063300

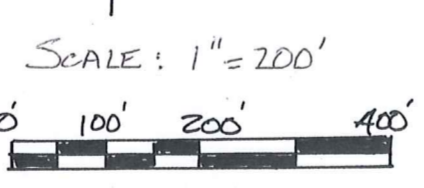

- = 5/8" CAPPED MCGUIRE REBARS FOUND UNLESS NOTED OTHERWISE
- ▲ = CITY OF AKRON CONCRETE MONUMENT WITH 2" DISC.

DOCUMENTS USED: ALL DEEDS SHOWN
ENVIRONMENTAL DESIGN GROUP SURVEY (EDG)
FOR CITY OF AKRON - SEPT. 1991
GUTOSKEY SURVEY FOR L. POLTZER - JUNE, 2004
MCGUIRE SURVEYS FOR KENVUE PROPERTIES, LLC
JULY 2000 AND FOR ANTHONY STACHOWSKI - NOV. 2016

DEED OF RECORD: 1739-2A68 TO ANTHONY STACHOWSKI, 32-063300

MAP OF SURVEY

FOR
ANTHONY STACHOWSKI
SECTION 12 OF TROY TOWNSHIP
GEAUGA COUNTY, OHIO
NOVEMBER 3, 2017

SURVEYED BY: CLIFFORD H. MCGUIRE
9487 SHANK ROAD
WINDHAM, OHIO 44288

I DO HEREBY CERTIFY THAT I HAVE SURVEYED THE PARCELS SHOWN HEREON AND THAT THIS MAP IS AN ACCURATE REPRESENTATION OF THAT SURVEY AND THAT THIS SURVEY WAS PERFORMED IN ACCORDANCE WITH THE PROVISIONS OF CHAPTER 4733-37 OF THE OHIO ADMINISTRATIVE CODE
Clifford H. McGuire
CLIFFORD H. MCGUIRE, P.S. #7770

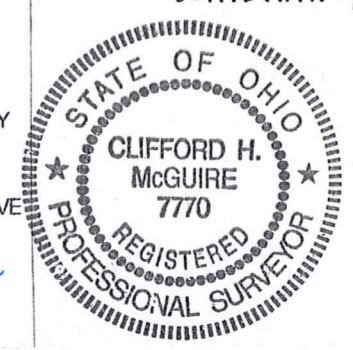

SURVEY PLAT & LEGAL DESCRIPTION APPROVED PER R.C. 315.251
WMB
11/03/17
GEAUGA COUNTY AUDITOR
TAX MAP DEPT.

TRO 00248
TRO 00248

Stachowski, Anthony (17-146)
Picked Up 11/09/17

Vol. 2042 Pg 3477
P# 32-063300

Clifford H. McGuire
Professional Surveyor No. 7770
9487 Shank Rd.
Windham, Ohio 44288

Description of Land
For
Anthony Stachowski

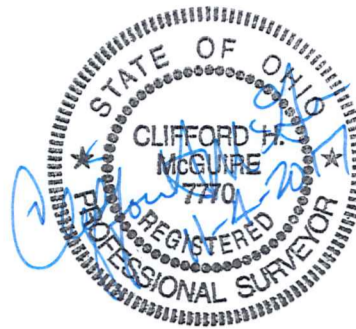

88.0843 Acre Residual,

Situated in the Township of Troy, County of Geauga, and State of Ohio, and known as being part of Section 12 of said township and further bounded and described as follows:

Beginning at a point on the centerline of Claridon Troy Road (S.R. 700, 60' R/W) at the southwest corner of lands conveyed to Keyvue Properties, LLC. by deed 1805-1733 of Geauga County Record of Deeds (GCRD) (P.N. 32-074338), said point being South 1° 21' 09" West, a distance of 598.21 feet from a bridge spike found at the centerline intersection of said Claridon Troy Road and Patch Road (60' R/W) and on the dividing line between Sections 11 and 12;

thence South 88° 24' 48" East, along the south line of said Keyvue Properties, LLC. (P.N. 32-074338) and passing over a 5/8" capped "McGuire" rebar found at 28.29 feet, a total distance of 258.29 feet to 5/8" capped "McGuire" rebar found at the southeast corner thereof;

thence North 1° 31' 00" East, along the east line of said Keyvue Properties, LLC. (P.N. 32-074338), a distance of 44.76 feet to a 5/8" capped "McGuire" rebar found at the southwest corner of lands conveyed to Keyvue Properties, LLC. by deed 1805-1735 (GCRD) (P.N. 32-074339);

thence South 88° 24' 48" East, along the south line of said Keyvue Properties, LLC. (P.N. 32-074339) and along the south line of lands conveyed to Keyvue Properties, LLC. by deed 1805-1737 (GCRD) (P.N. 32-074340) and Keyvue Properties, LLC. by deed 1805-1739 (GCRD) (P.N. 32-074341), a distance of 750.00 feet to a 5/8" capped "McGuire" rebar found at the southeast corner thereof and at the southwest corner of lands conveyed to Keyvue Properties, LLC. by deed 1805-1741 (GCRD) (P.N. 32-074324);

thence South 71° 40' 37" East, along the south line of said Keyvue Properties, LLC. (P.N. 32-074324), a distance of 253.55 feet to a 5/8" capped "McGuire" rebar found at the southeast corner thereof and on the west line of lands conveyed to Anthony Stachowski by deed 2024-2891 (GCRD) (P.N. 32-074396);

thence South 1° 31' 00" West, along the west line of said Anthony Stachowski (P.N. 32-074396), a distance of 532.56 feet to a 5/8" capped "McGuire" rebar found at the southwest corner thereof;

thence South 86° 10' 00" East, along the south line of said Anthony Stachowski (P.N. 32-074396) and along the south lines of two other parcels conveyed to said Anthony Stachowski by said same deed (P.N. 32-074397 and P.N. 32-074398 respectively), a distance of 719.13 feet to a 5/8" capped "McGuire" rebar found at the southeast corner thereof and on the west line of other lands conveyed to Anthony Stachowski by deed 2024-2891 (GCRD) (P.N. 32-074399);

thence South 1° 31' 00" West, along the west line of said Anthony Stachowski (P.N. 32-074399), a distance of 1558.61 feet to a 5/8" capped "McGuire" rebar found at the southwest corner thereof and on the north line of lands conveyed to Ute C. Reid, Tr. by deed 574-456 (GCRD) (P.N. 32-055200);

Page 2, 88.0843 Acres,

thence North 88° 04' 40" West, along the north line of said Ute C. Reid, Tr. (P.N. 32-055200 and P.N. 32-055300), a distance of 1593.11 feet to a concrete City of Akron monument with a 2" disc found at the northeast corner of lands conveyed to City of Akron by deed 186-17 (GCRD) (P.N. 32-702561);

thence North 87° 47' 31" West, along the north line of City of Akron (P.N. 32-702561) and passing over a 1 1/2" iron pipe found at 319.66 feet, a total distance of 349.03 feet to a point on said centerline;

thence North 3° 09' 21" West, along said road centerline, a distance of 358.30 feet to a 5/8" iron pin found at an angle point;

thence North 1° 36' 22" East, continuing along said road centerline, a distance of 333.51 feet to a 1/2" iron pin found at an angle point;

thence North 1° 35' 17" East, continuing along said road centerline, a distance of 1296.36 feet to a 5/8" bent iron pin found at an angle point;

thence North 1° 21' 09" East, continuing along said road centerline, a distance of 147.56 feet to the point of beginning and containing 88.0843 acres of land (1.4710 acres in road right-of-way) as surveyed in November, 2017 by Clifford H. McGuire, Professional Surveyor No. 7770.

Basis of bearing for the centerline of Patch Road was deed 1750-1031. The intent of this description is to delineate the residual of lands conveyed to Anthony Stachowski by deed 1739-2468 (P.N. 32-063300) after a number of splits recorded September, 2006 and December, 2016.

SURVEY PLAT & LEGAL DESCRIPTION
APPROVED PER R.C. 315.251

[Signature] 11/08/17
GEAUGA COUNTY AUDITOR
TAX MAP DEPT.

RECEIVED

NOV 10 2017
GEAUGA COUNTY AUDITOR
TAX MAP DEPT.